

COPYRIGHT:
The design and details shown on this drawing are applicable to the Named Project only and may not be reproduced, modified or copied in whole or part to be used for any other project or purpose without the prior written permission of TOT Architects with whose copyright resides.

DO NOT SCALE: This drawing, using figured dimensions only. The Contractor is responsible for checking all levels and dimensions on site prior to commencement of works. Any discrepancies are to be referred to the ARCHITECT.

Drawings to be read in conjunction with all other Consultants Drawings & Specifications: where relevant. Proprietary items shall be fixed in strict accordance with the Manufacturers' Instructions. Sizes of proprietary items shall be checked with Manufacturer.

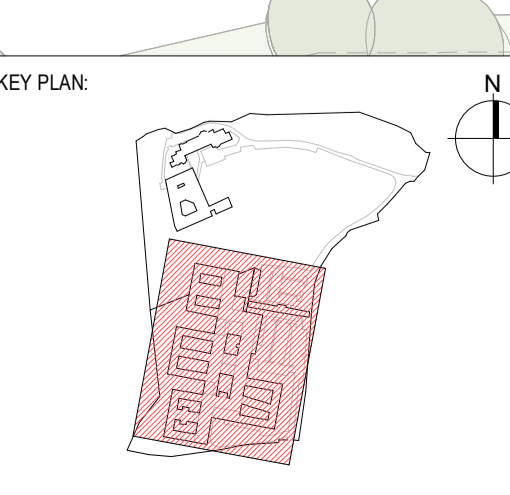

- EXISTING TREES
- PROPOSED TREES
- PUBLIC ACCESS AREAS
- MAIN CIRCULATION
- WARD CIRCULATION
- PROTECTED / RETAINED STRUCTURE
- LAND TO BE GRANTED TO SDCG FOR ROAD IMPROVEMENT SUBJECT TO GRANT OF PERMISSION
- ST EDMUNDSBURY WALKING LOOP
- PROPOSED RESULT STRUCTURE

| REVISIONS | DATE | REV | ISSUED FOR PLANNING | DESCRIPTION |
|-----------|------------|-----|---------------------|-------------|
| 10626 | 9/10/2022 | 1 | ISSUED FOR PLANNING | |
| 10626 | 10/10/2022 | 2 | ISSUED FOR PLANNING | |

TOT ARCHITECTS

REGISTERED OFFICE:
49 Upper Mount Street
Dublin 2, D02 PR85, Ireland

T: +353 1 705 7000
W: www.totarch.ie
E: info@totarch.ie

| | | | | | | | | | |
|----------------|----------------------------------|------------------|-------|---------------|------|-----------|-------|---------------------------------------|---|
| CLIENT: | SPUH | DRAWN: | MA | CHECKED: | DS | APPROVED: | DS | DATE: | 17/04/2026 |
| PROJECT: | St Edmundsbury Hospital Lucan | NUMBER: | 20-77 | SHEET SIZE: | A0 P | SCALE: | 1:200 | INFORMATION CONTAINER IDENTIFICATION: | SPMHS - MH - MLO - DR - TOT - AR - 2101 |
| PROJECT STAGE: | Planning | ACCEPTANCE CODE: | S | PURPOSE CODE: | P3 | REVISION: | 0 | | |

0m 10m 20m